

HOSEBED CAPACITIES	
①	300' OF 1.75" D.J. HOSE
②	300' OF 2.00" D.J. HOSE
③	300' OF 3.00" D.J. HOSE
④	1200' OF 5.00" D.J. HOSE
⑤	200' OF 2.50" D.J. HOSE
⑥	150' OF 3.00" D.J. HOSE

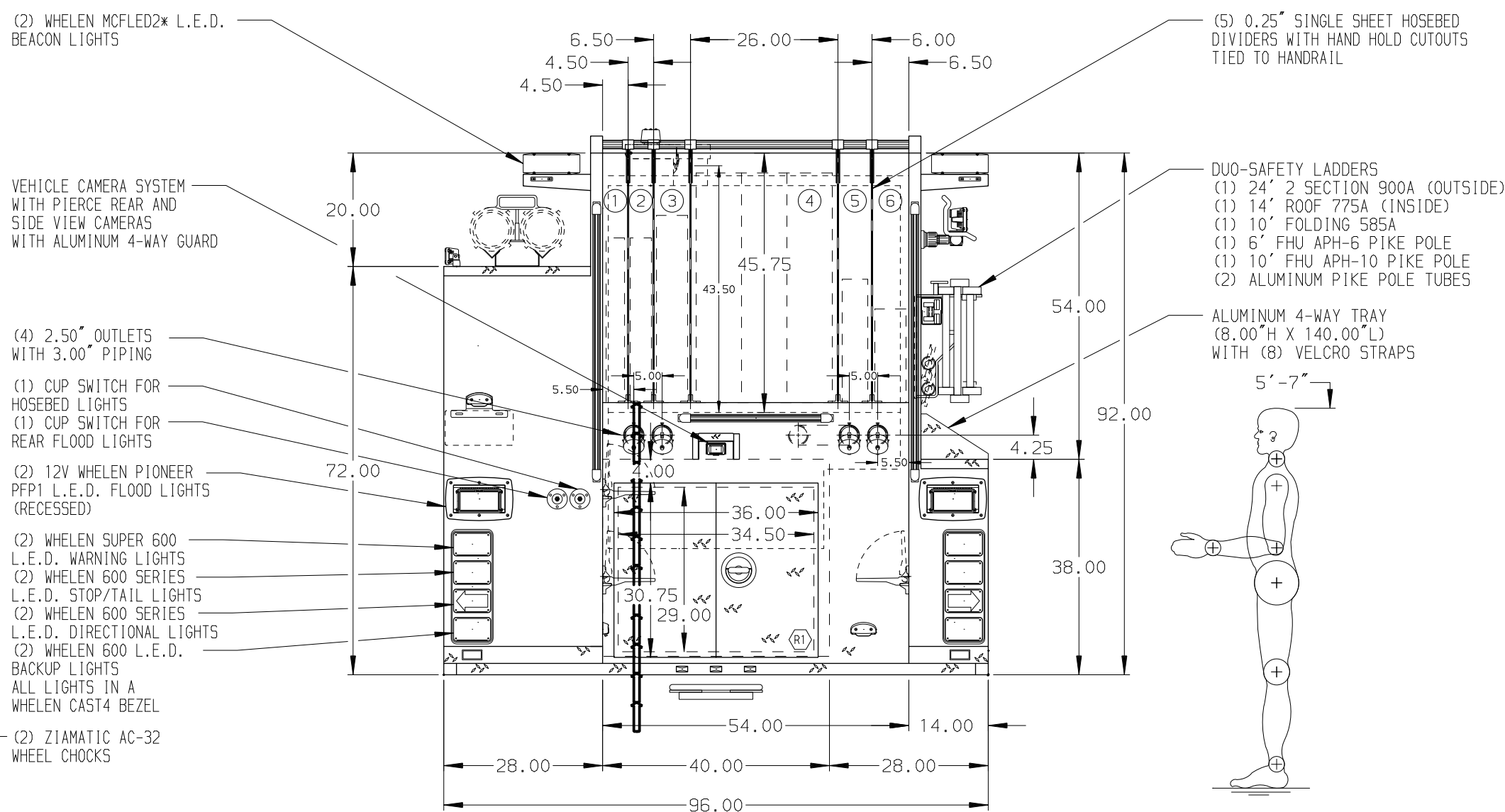

ALUMINUM BODY

SIDE ROLL AND FRONTAL IMPACT PROTECTION

NOTE
DIMENSIONS SHOWN ARE APPROXIMATE AND ARE SUBJECT TO MINOR DEVIATIONS AS MAY OCCUR OR BE NECESSARY IN CONSTRUCTION.
MINOR DETAILS NOT SHOWN.

- KUSSMAUL PUMP PLUS 1200 BATTERY CHARGER/AIR COMPRESSOR LOCATED BEHIND DRIVER'S SEAT
- BATTERY CHARGER INDICATOR LOCATED ON DRIVER'S SEAT RISER
- REVERSED HINGED DOOR ON COMPARTMENTS D3 & D2
- ONE FLOOR MOUNTED FULL WIDTH/DEPTH SLIDE-OUT TRAY IN COMPARTMENT D1
- PARTITION BETWEEN COMPARTMENTS D1/R1 AND P1/R1
- AIR INLET WITH DISCONNECT COUPLING LOCATED ON D.S. PUMP PANEL
- AIR OUTLET WITH SHUT OFF VALVE LOCATED ON D.S. PUMP PANEL
- EXTERNAL FOAM SYSTEM
- ONE 20A, 120V 6-PLACE RECEPTACLE STRIP BEHIND DRIVER'S SEAT AND IN EACH EMS CABINET

CUSTOMER APPROVAL

APPROVED BY: _____
DATE: _____

REV	DATE	BY	CH	ENFORCER



MANUFACTURING INC.

TITLE 1500-D-500P W/20 GAL FOAM, 140" FH FD DS, LOW PS
FOR HARRISBURG BUREAU OF FIRE
HARRISBURG, PENNSYLVANIA

DWG NO. 30249AD

JOB NO.	30249
SCALE	1:24
DATE	
DRAWN BY	NPA
CHECKED BY	CSH
SHEET SIZE	D
SHEET NO.	1 OF 1