

PUMPER BODY

Long Aluminum 2nd Gen Pumper

CHASSIS

Enforcer Chassis

CHASSIS AXLE, FRONT, CUSTOM

19,500 Lb TAK-4 Axle

AXLE, REAR

24,000 Lb Meritor Axle

ENGINE

525 HP DD13 Engine

TRANSMISSION

Allison 5th Gen, 4000 EVS P

BUMPER

22" Extended Stainless Steel

CAB

7010 Enforcer Cab

BODY

WATER TANK

720 Gallon Poly Water Tank

COMPT, PUMPER, REAR

44.50" FF RollUp Rear Compt

COMPT, PUMPER, DRIVER SIDE

161" Lap Full Height & Depth Front & Rear

COMPT, PUMPER PASS. SIDE

161" Lap Full Height Front & Rear FOLER

FIRE SUPPRESSION PUMPHOUSE

45" Control Zone Side Mount

PUMP

1250 GPM Waterous CSU

CROSSLAYS, 1.50"

(1) 1.50" Special Capacity

CROSSLAYS, 2.50"

2.50" Crosslay Not Required

SPEEDLAYS

(2) 1.50" Standard Capacity

GENERATOR

Harrison 6kW MAS-D Hydraulic Generator

Foam System

Husky 3 Single Agent Foam System

Foam Cell

30 Gallon Foam Cell, Reduced Water

Side Roll and Frontal Impact Protection

NOTE

DIMENSIONS SHOWN ARE APPROXIMATE AND ARE SUBJECT TO MINOR DEVIATIONS AS MAY OCCUR OR BE NECESSARY IN CONSTRUCTION. MINOR DETAILS NOT SHOWN.

- SHORELINE RECEPTACLE WITH KUSSMAUL SUPER AUTO-EJECT LOCATED ON PASSENGER SIDE OF THE CAB
- AIR INLET WITH DISCONNECT COUPLING ON PASSENGER SIDE OF THE CAB
- BATTERY CHARGER LOCATED BEHIND DRIVERS SEAT
- BATTERY CHARGE INDICATOR DISPLAYED THROUGH PS CAB WINDOW
- FOUR ADJUSTABLE SHELVES LOCATED PER SHOP ORDER
- TWO FLOOR MOUNTED SLIDE-OUT TRAY LOCATED PER SHOP ORDER
- CIRCUIT BREAKER PANEL LOCATED IN COMPARTMENT D3
- TWO ZICO SCBA BRACKETS LOCATED PER SHOP ORDER
- FIVE ALUMINUM PEGBOARD LOCATED ON COMPARTMENT WALLS PER SHOP ORDER

- PARTITION BETWEEN COMPARTMENTS D1/R1 AND P1/R1
- ONE AKRON CORD REEL MODEL ERWC-15-10 WITH 200' OF 10/3 CABLE LOCATED IN COMPARTMENT D3
- HANNAY BOOSTER REEL MODEL SBFF34-23-24 WITH CAPACITY FOR 200' OF 1.00" BOOSTER HOSE LOCATED IN CARGO AREA
- FIVE 120V DUPLEX RECEPTACLES LOCATED PER SHOP ORDER
- ONE 120V 6-PLACE RECEPTACLE LOCATED PER SHOP ORDER
- TWO FLOOR MOUNTED SLIDE-OUT TRAYS W/ SIDE SLIDES LOCATED PER SHOP ORDER
- ONE ADJUSTABLE HEIGHT SLIDE-OUT TRAY LOCATED PER SHOP ORDER

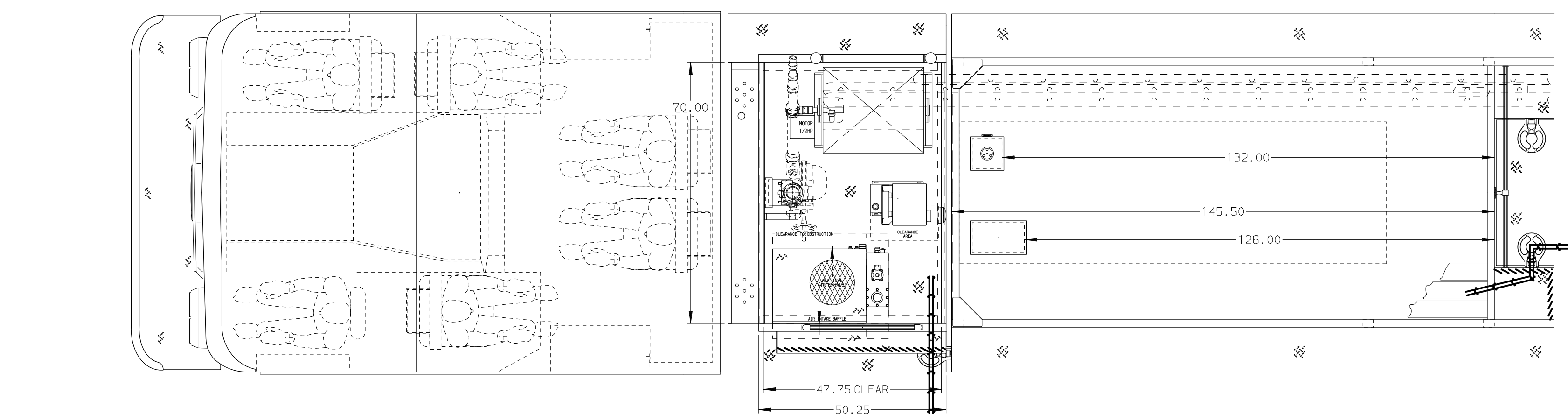
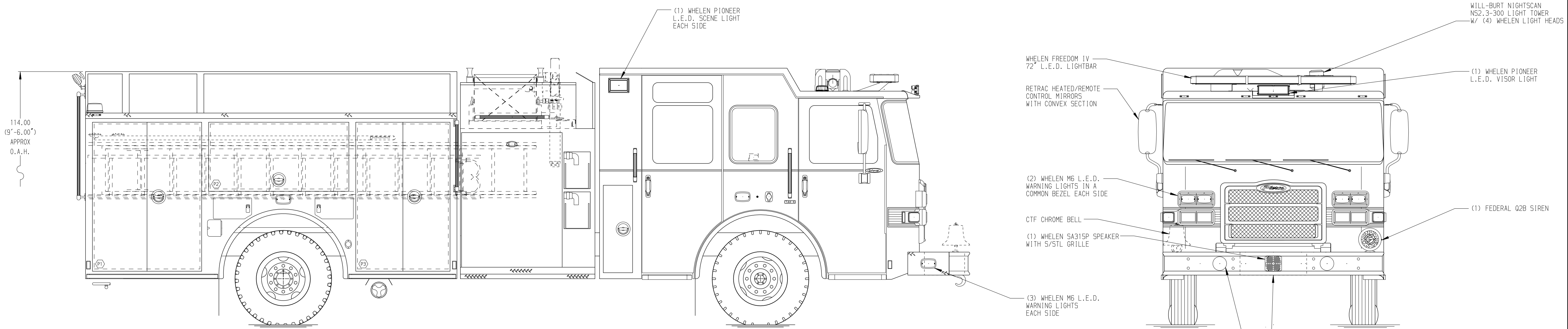

HOSEBED CAPACITY	
BED 1	300' OF 2.50" D.J. POLY HOSE
BED 2	950' OF 3.00" D.J. POLY HOSE
BED 3	950' OF 3.00" D.J. POLY HOSE
BED 4	300' OF 1.75" D.J. POLY HOSE

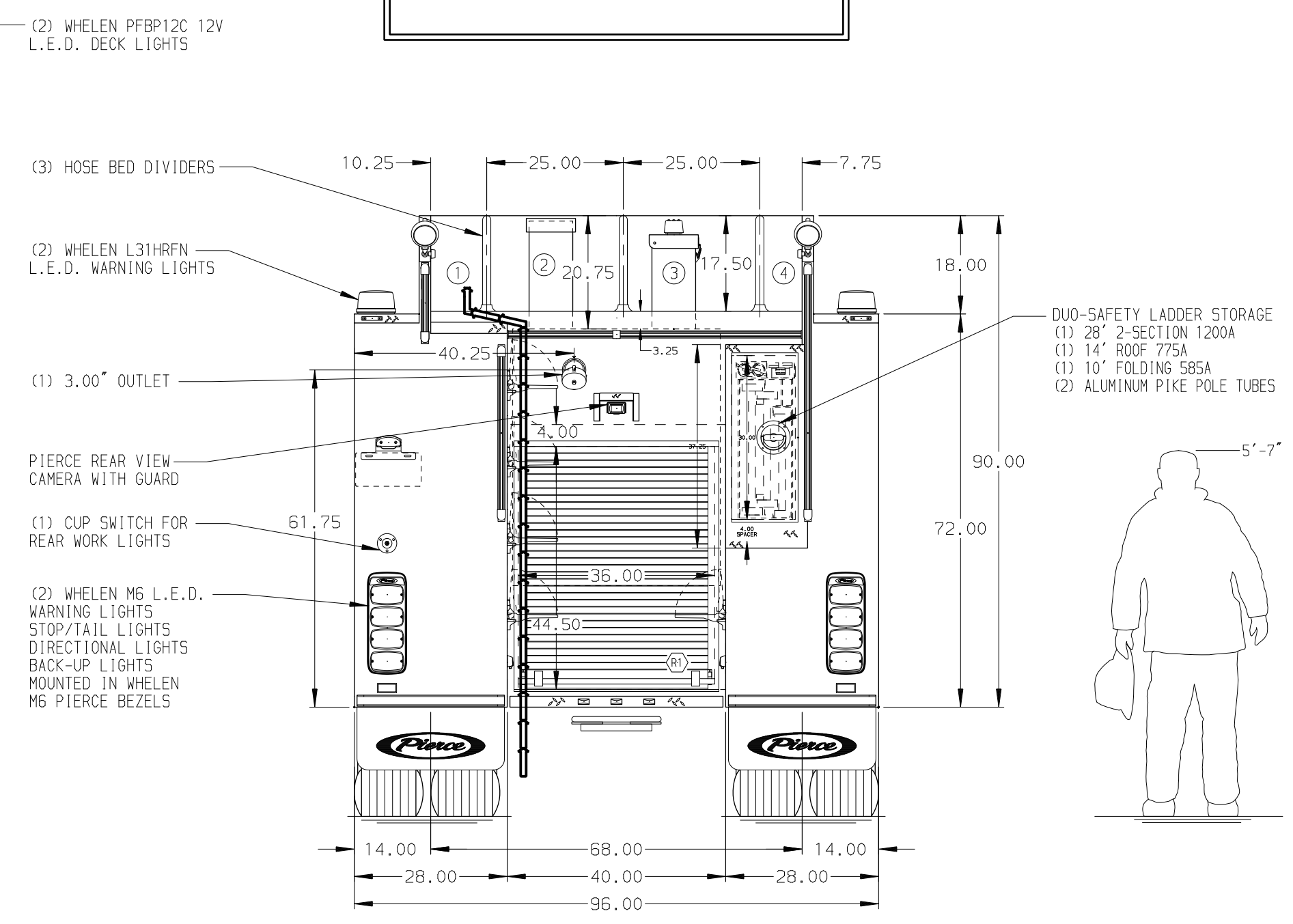
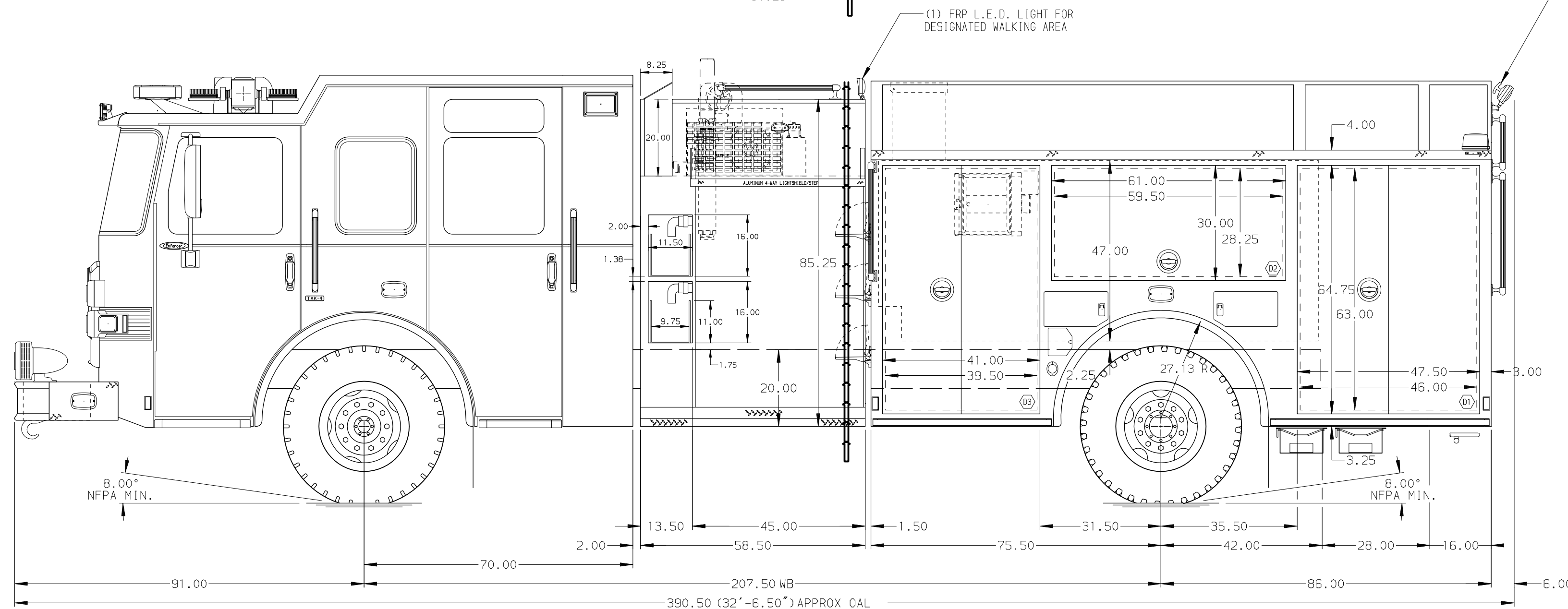

MAXIMUM O.A.H. - 114.00"

MAXIMUM O.A.L. - 393.50"

		JOB NO.	31216
		SCALE	DATE
TITLE	Pierce Pumper Approval Drawing	DRAWN BY	COL
FOR	Borough of Oakmont	CHECKED BY	SHE
DWG NO.	31216AD	SHEET SIZE	SHEET NO.
		D	1 OF 1

REV	DATE	BY	CH	ENFORCER
17JUL17	COL	J60		PIERCE
13JUN17	COL	SHE		MODEL