

HOSEBED CAPACITIES

① 1100' OF 5.00" D.J. HOSE

② 450' OF 3.00" D.J. HOSE

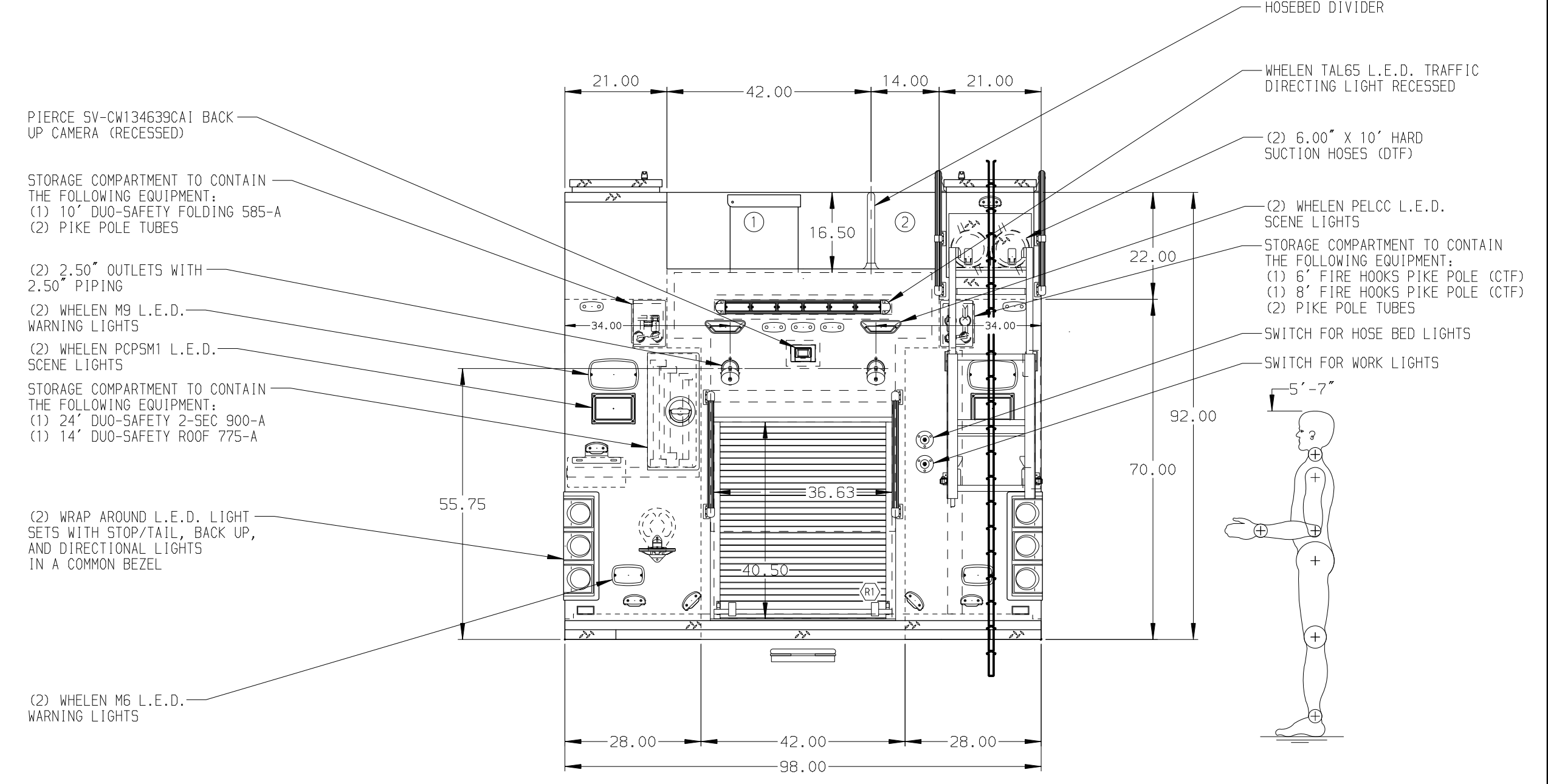
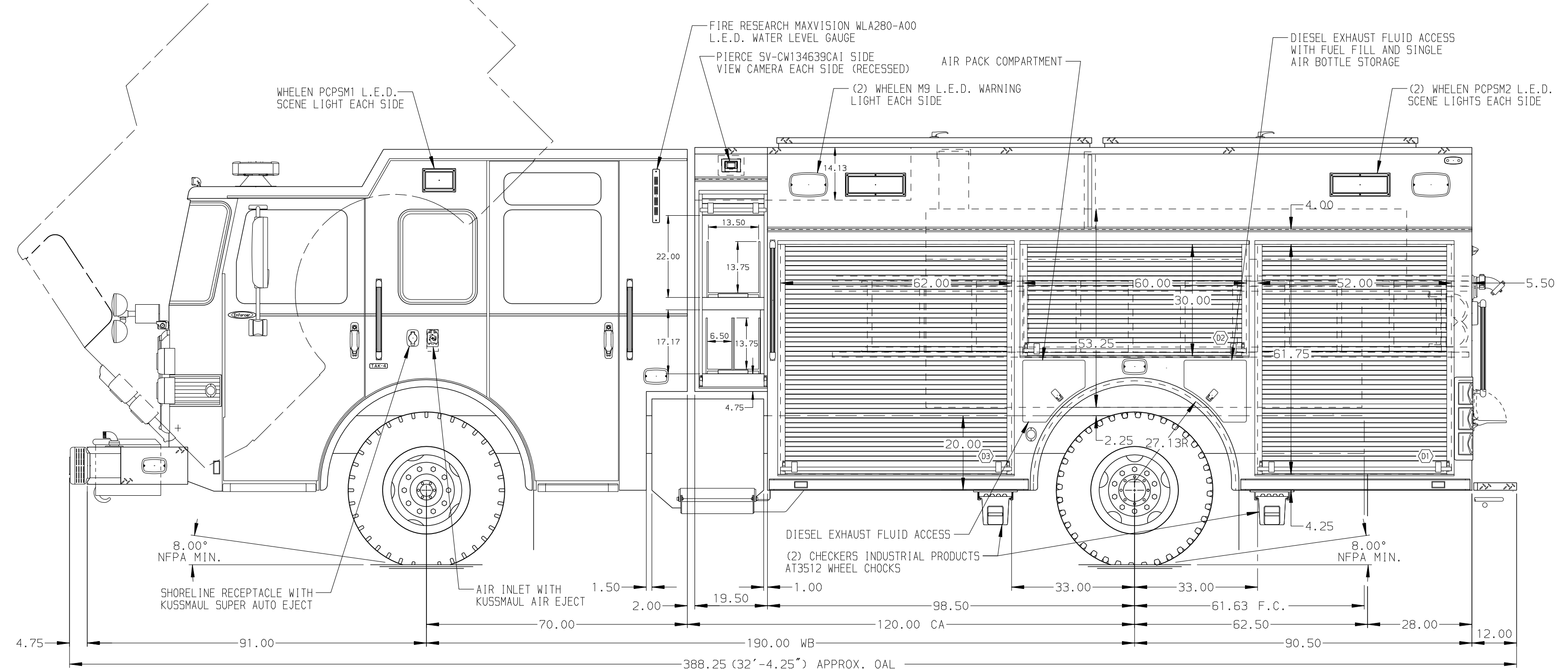

ALUMINUM BODY SIDE ROLL & FRONTAL IMPACT PROTECTION

NOTE
DIMENSIONS SHOWN ARE APPROXIMATE AND ARE SUBJECT TO MINOR DEVIATIONS AS MAY OCCUR OR BE NECESSARY IN CONSTRUCTION. MINOR DETAILS NOT SHOWN.

- BATTERY CHARGER LOCATED IN PUMP PLUMBING AREA
- BATTERY CHARGER INDICATOR LOCATED ON DRIVER SIDE SEAT RISER
- AMDR LUMBAR L.E.D. WALKING SURFACE LIGHTING LOCATED IN THE CARGO AREA
- ONE FULL WIDTH/DEPTH ADJUSTABLE SHELF WITH 2' SIDES IN COMPARTMENT-D1,D3,P1, THREE IN P3
- ONE ADJUSTABLE SLIDE-OUT TRAY WITH 2' SIDES IN COMPARTMENT-R1
- ONE ADJUSTABLE FULL WIDTH/DEPTH TILT/SLIDE-OUT TRAY IN COMPARTMENT-P1,P2
- ONE FLOOR MOUNTED SLIDE-OUT TRAY WITH 2' SIDES IN COMPARTMENT-P1
- ONE SLIDE-OUT TOOLBOARD WITH PEGBOARD PATTERN IN COMPARTMENT-P3
- VERTICAL BOLT-IN PARTITIONS BETWEEN COMPARTMENTS D1/R1 AND P1/R1
- ONE VERTICAL PARTITION IN COMPARTMENT-P3
- PEGBOARD WITH TRACKS ON REAR WALL IN COMPARTMENT-D1,D2,D3
- GROVER TRIPLE AIR HORN CLUSTER MOUNTED BEHIND BUMPER

REV	DATE	BY	CH	ENFORCER
10MAR17	BST	DTS		CHASSIS DATA
13FEB17	BST	DTS		MAKE
04JAN17	BST	DTS		PIERCE
12DEC16	BST	CSH		MODEL

		JOB NO.	30680
		SCALE	DATE
TITLE	1500-D-1000P, 189" PUC RESCUE BODY, (3) CROSSLAYS LADDERS THRU BODY	DRAWN BY	BST
FOR	UPPER LEACOCK FIRE COMPANY LEOLA, PA	CHECKED BY	CSH
DWG NO.	30680AD	SHEET SIZE	SHEET NO.
		D	1 OF 1